

商品介紹 Product description

體積小・緊迫力強。

- 材質：不鏽鋼(SUS304)、冷軋鋼板(SPCC)
- 表面處理：滾筒拋光、鍍鋅
- 用途：半導體設備、配電盤等

It is small sized and has a strong force of tightening.

- Material: Stainless(SUS304), Cold rolling steel sheet(SPCC)
- Finish: Barrel polishing,Zinc plating
- Uses: Semiconductor equipment, distributing panel,etc.

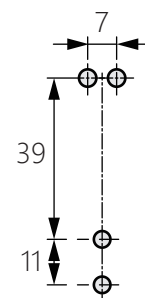
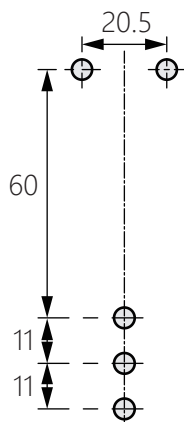
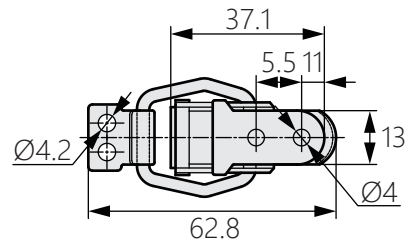
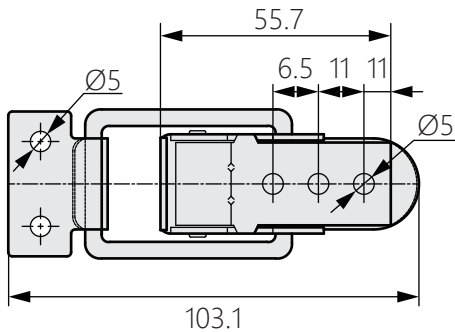
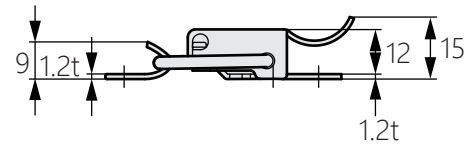
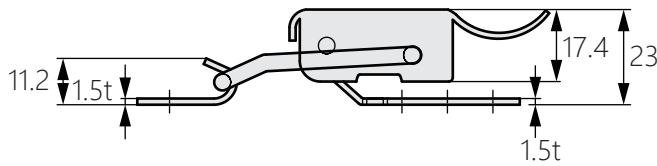
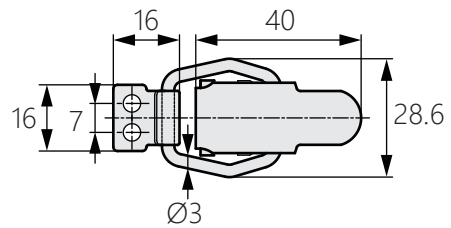
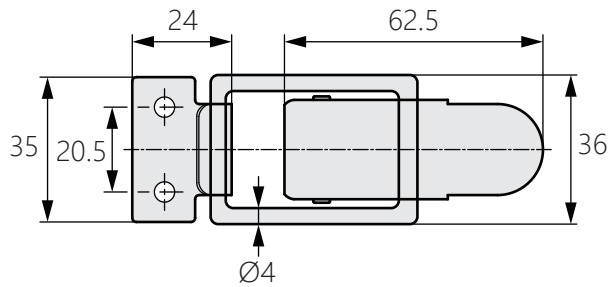

[ TM-069-1-2 ] 冷軋鋼板  
[ TM-069-2-2 ] 不鏽鋼

[ TM-069-1-1 ] 冷軋鋼板  
[ TM-069-2-1 ] 不鏽鋼