

商品介紹 Product description

使用滾輪可以順暢地打開和關閉。

- 材質：冷軋鋼板(SPCC)
- 表面處理：鍍鋅
- 用途：測量儀器、辦公自動化設備、家具等

The opening and closing are smooth using rollers.

- Material: Cold rolling steel sheet(SPCC)
- Finish: Zinc plating
- Uses: Measuring instrument,OA equipment, furniture,etc.

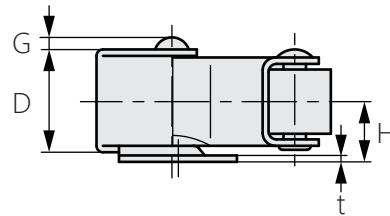
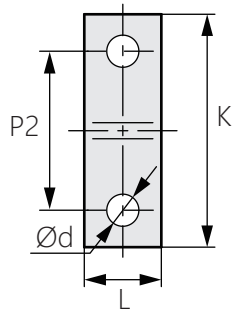
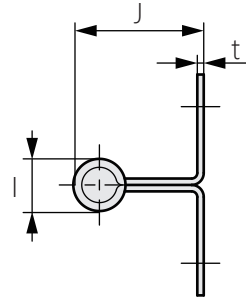
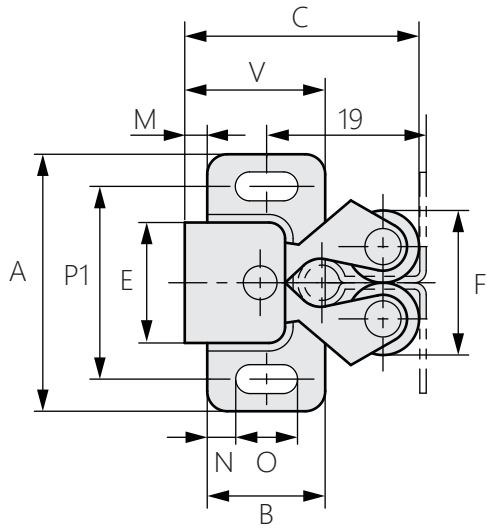

商品型號	A	B	C	D	E	F	G	H	I	J	K	L	M
DK-082-1	32	14.7	28.5	14.5	16	17.8	1.5	7.5	6.5	16.5	29	9.6	2.8
DK-082-2	28	12.5	23.5	12	13	14	1	6.5	4.5	12	23	7	2.5

商品型號	N	O	P1	P2	Q	Ød	t	V	吸附力 kgf
DK-082-1	3.5	7.7	24	19.8	3.6	4	0.8	17.5	2.5
DK-082-2	2.5	7.5	20	17	2.8	3	0.6	15	1.5