

彈簧迫緊搭扣

Spring-loaded buckle



DK-326



商品介紹 Product description

- 1.可安裝於側門或平門。
- 2.帶彈簧結構，迫緊程度更強。
- 3.彎折式鉤子，提升鉤子強度。

- 材質：不鏽鋼(SUS304)、鐵(SPCC)
- 表面處理：震動研磨、鍍鎳
- 用途：機箱機櫃、工業箱體等

1. Can be installed on side door or flat door.
2. With spring structure, the tightness is stronger.
3. Bending hook to improve hook strength.

- Material: Stainless steel(SUS304),iron(SPCC)
- Finish: Vibration grinding,nickel plating
- Uses: Chassis cabinets,industrial cabinets,etc.

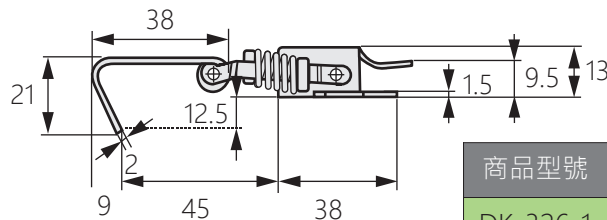
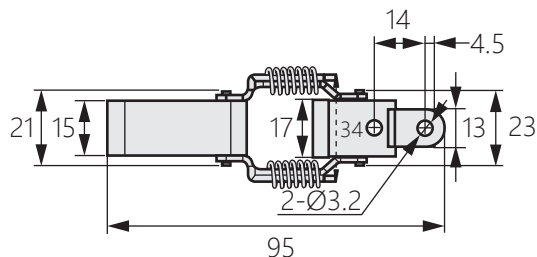

商品型號	材質
DK-326-1	不鏽鋼
DK-326-2	鐵