

帶鎖孔搭扣

With keyhole buckle

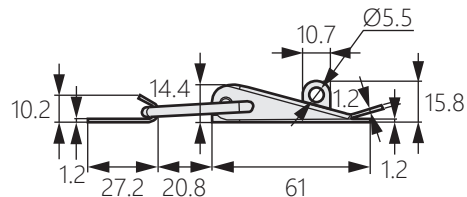

DK-8002

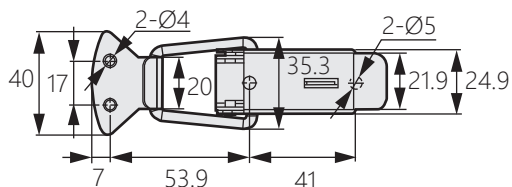

商品介紹 Product description

- 1.可安裝於側門或平門。
- 2.左右兼用型。

- 材質：不鏽鋼SUS304、鐵
- 表面處理：震動研磨、鍍鎳
- 用途：櫃門、電箱電櫃等

- 1.Can be installed on side doors or flat doors.
- 2.Both left and right type.

- Material: Stainless steel SUS304,iron
- Finish: Vibration grinding,nickel plated.
- Uses: Oven equipment,test chambers,etc.

商品型號	材質	表面處理
DK-8002-1	不鏽鋼	震動研磨
DK-8002-2	鐵	鍍鎳