

CRW型交叉滾柱導軌

CRW-type cross roller guide

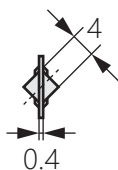

HG-CRW4

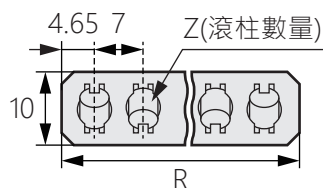
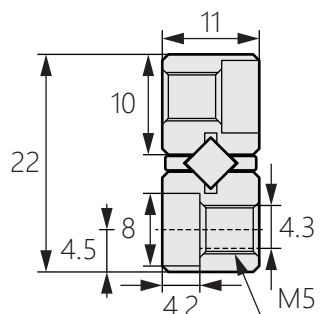

商品介紹 Product description

1. 安裝簡易方便。
2. 內有防蠕動齒輪，可防止保持架錯位。
3. 快速平穩的滾動運動。
4. CRW4型交叉滾柱保持架的最大長度是700mm。

● 材質：導軌-軸承鋼、保持架-不鏽鋼

1. Easy and convenient installation.
2. Equipped with anti-creep gears inside to prevent misalignment of the cage.
3. Fast and smooth rolling motion.
4. The maximum length of CRW4 type crossed roller cage is 700mm.

● Material: Guide rail-bearing steel
Cage-Stainless steel

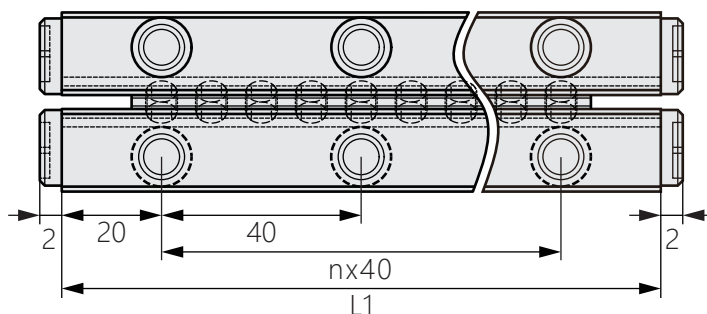

商品型號	L1	nx40	R	Z	最大行程(mm)
HG-CRW4-80X7Z	80	1x40	51	7	62
HG-CRW4-120X11Z	120	2x40	79	11	86
HG-CRW4-160X15Z	160	3x40	107	15	110
HG-CRW4-200X19Z	200	4x40	135	19	134
HG-CRW4-240X23Z	240	5x40	163	23	158
HG-CRW4-280X27Z	280	6x40	191	27	182
HG-CRW4-320X31Z	320	7x40	219	31	206
HG-CRW4-360X35Z	360	8x40	247	35	230
HG-CRW4-400X39Z	400	9x40	275	39	254
HG-CRW4-440X43Z	440	10x40	303	43	278
HG-CRW4-480X47Z	480	11x40	331	47	302