

# 日式支架腳輪



JZ-612

## Japanese bracket caster

### 商品介紹 Product description



- 1.一體拉伸成型支架。
- 2.雙層滾珠設計。
- 3.一體成型雙軸單輪。

- 材質：雙軸單PA、MC、PU輪
- 用途：家俱、輕型物流台車、一般手推車、輕型機械設備

1. One-piece stretch forming bracket.
2. Double-layer ball design.
3. One-piece double-axle single wheel.

- Material: Double-axis single PA,MC,PU wheel
- Uses: Furniture, light logistics trolleys, general trolleys, light machinery and equipment.

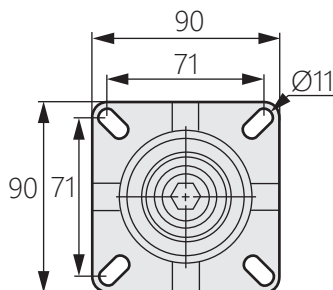

J5底板尺寸

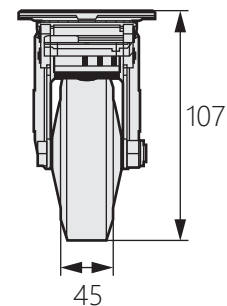
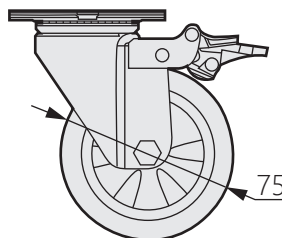

商品型號	輪子	輪徑 (W1)	輪寬 (W2)	安裝高度 (H)	底板尺寸 (L1*L2)	孔距 (P1-P2)	孔徑 (D2)	荷重 (KG)
JZ-612-1-1	PA	63	38	92	90*90	71*71	9	300
JZ-612-1-2		75		105				400
JZ-612-2-1	MC	63		92				300
JZ-612-2-2		75		105				500
JZ-612-3-1	PU	63		92				300
JZ-612-3-2		75		105				300