

滾輪型壓入式球頭柱塞

Roller type press-in ball plunger



LZ-113

商品介紹 Product description

易安裝 · 無須螺紋調節。

Easy to install, no thread adjustment required.

● 材質：主體-SUS303、珠子-SUS440C、彈簧-SUS304

● Material: Main Body-SUS303, Bead - SUS440C, Spring - SUS304

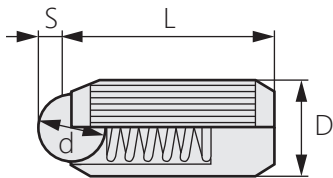

| 商品型號 | D | L | S | d | 彈力 (N) | | | |
|----------|------|------|-----|------|--------|------|------|-----|
| | | | | | 1H | | 2H | |
| | | | | | min | max | min | max |
| LZ-113-1 | 3.9 | 7.36 | 0.9 | 2.38 | 1.8 | 5.9 | 3.4 | 12 |
| LZ-113-2 | 5.46 | 11 | 1.5 | 4 | 4.5 | 11 | 9 | 22 |
| LZ-113-3 | 6.58 | 13.2 | 1.8 | 4.78 | 6.8 | 16 | 13.5 | 32 |
| LZ-113-4 | 8.15 | 17.8 | 2.3 | 6.35 | 9 | 22.5 | 18 | 45 |
| LZ-113-5 | 9.75 | 22 | 2.8 | 8 | 11 | 31.5 | 22 | 63 |
| LZ-113-6 | 12.9 | 30.8 | 4 | 11 | 18 | 40.5 | 36 | 81 |