

法蘭安裝型鋼珠滾輪



LZ-407

Flange mounted steel ball roller

商品介紹 Product description

易安裝 · 好調整 · 用於定位及鎖定功能。

Easy to install, easy to adjust, for positioning and locking functions.

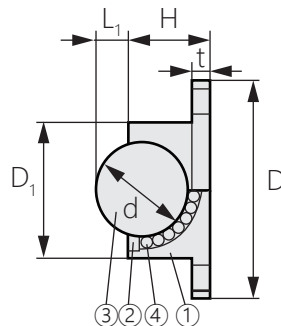
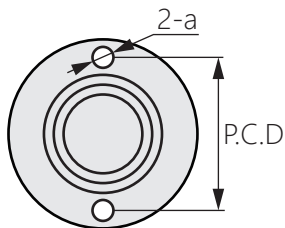

商品型號	D	D1	L1	H	t	P.C.D	a	d	耐負載 (N)
LZ-407-1	27	15	2.5	9.5	2	21	3.5	8.73	55
LZ-407-2	30	18	3.5	11.5	2	24	3.5	10.32	62
LZ-407-3	39	24	5.3	14.7	3	31.5	4.5	15.87	343
LZ-407-4	48	30	6.3	18.7	4	39	5.5	19.02	412