

# 不鏽鋼鉸鍊

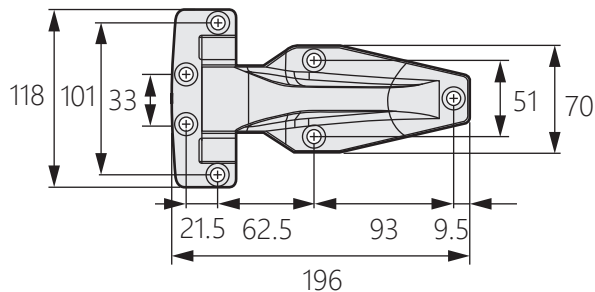

# OH-0214

## Stainless steel hinge

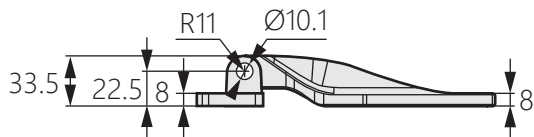

## 商品介紹 Product description

- 1.左右兼用型。
- 2.最大開啟角度180度。
- 3.全不鏽鋼實心鑄造，承重性強。

- 材質：不鏽鋼(SUS304)
- 表面處理：鏡面拋光
- 用途：重型設備、烤箱、試驗箱

1. Both left and right use type.
2. The maximum opening angle is 180 degrees.
3. All stainless steel solid casting, strong load-bearing ability.

- Material: Stainless steel(SUS304)
- Finish: Mirror polishing
- Uses: Heavy equipment, ovens, test chambers.

安裝示意圖

