

外露式鉸鍊

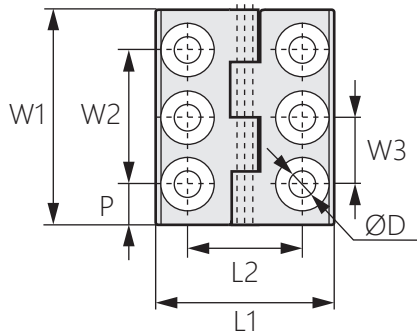

OH-0221

Exposed hinge



商品介紹 Product description

- 1.六孔安裝・左右兼用型。
- 2.最大開啟角度180度。

- 材質：鋅合金(ZDC)
- 表面處理：無光黑
- 用途：機床、自動化設備等。

1. Six-hole installation, both left and right type.
2. The maximum opening angle is 180 degrees.

- Material: Zinc alloy(ZDC)
- Finish: Matt black
- Uses: Machine tools, automation equipment, etc.

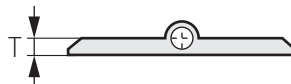

商品型號	L1	L2	W1	W2	W3	D	P	T
OH-0221-1	55	38	65	40	20	7	12.5	5.5
OH-0221-2	65	42	80	50	25	8.5	15	