

Stainless steel quick release hinge

商品介紹 Product description

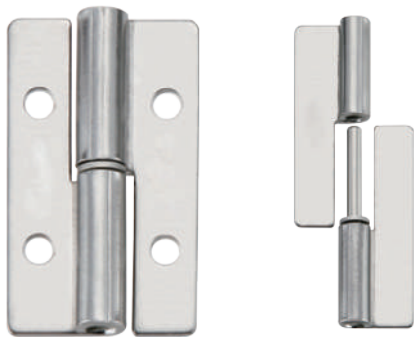

- 1.左右開門分別。
- 2.可輕鬆、快速且安全的將門卸下。
- 3.具出色的耐久性及抗腐蝕能力。

- 材質：不鏽鋼SUS304
- 表面處理：震動研磨
- 用途：電子設備外殼、工業機箱等

1. Open the door separately.
2. The door can be removed easily, quickly and safely.
3. Has excellent durability and corrosion resistance.

- Material: Stainless steel(SUS304)
- Finish: Vibration grinding
- Uses: Electronic equipment enclosures, industrial cases, etc.

[OH-1004-1-R]
[OH-1004-2-R]

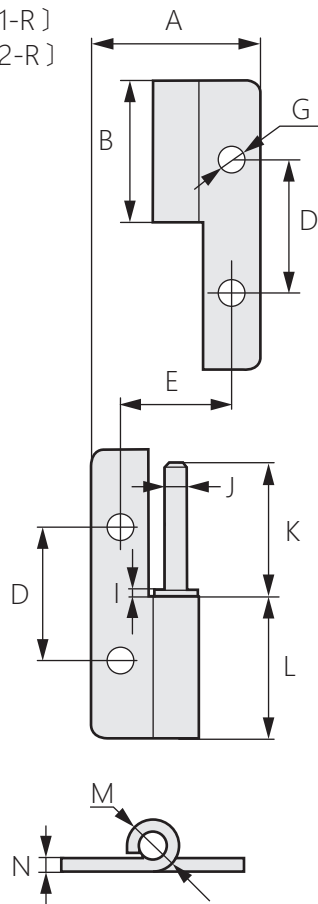

安裝示意圖

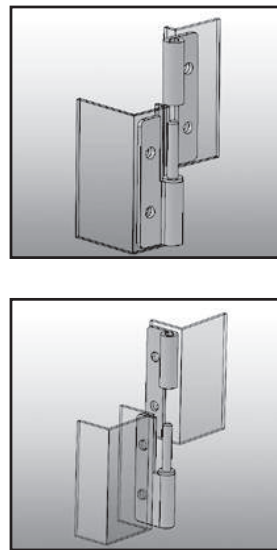

[OH-1004-1-L]
[OH-1004-2-L]

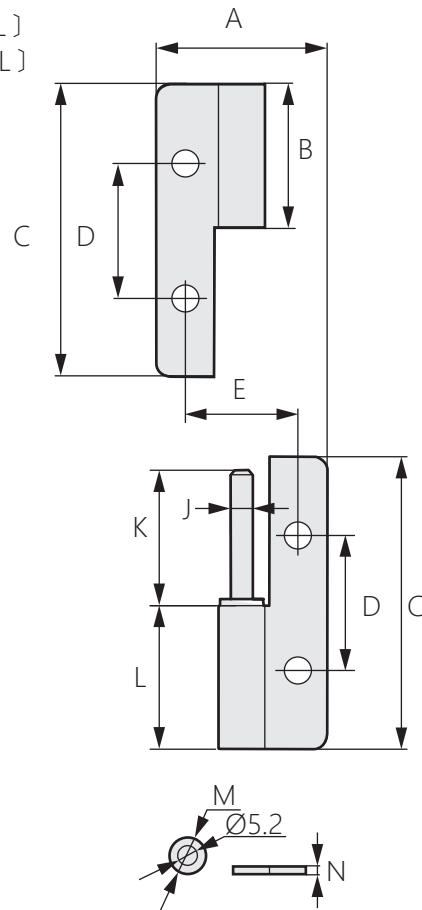

商品型號	結構	A	B	C	D	E	J	K	L	I	G	M	N
OH-1004-1-R	無孔	38	31.9	65	30	25	5	30.1	31.9	1.5	4*Ø6	Ø10.3	2.5
OH-1004-1-L	無孔											Ø9.7	1.5
OH-1004-2-R	有孔				Ø10.3	2.5							
OH-1004-2-L	有孔				Ø9.7	1.5							