

冷凍庫鉸鍊

Freezer hinge

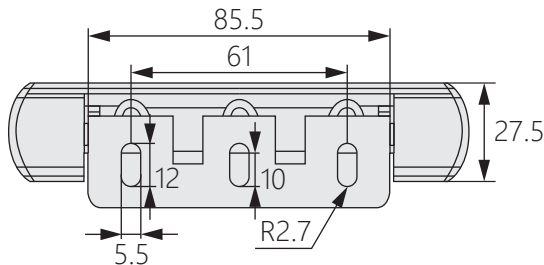

OH-1441

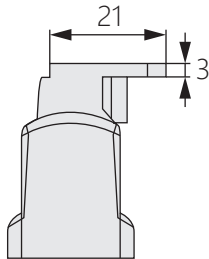

商品介紹 Product description

- 1.最大開啟角度180度。
- 2.凸門結構設計，適合安裝於凸門的箱體。
- 3.帶彈簧鉸鍊，具自動回位功能。
- 4.帶鉸鏈蓋，安裝後無安裝痕跡。

- 材質：鋅合金(ZDC)
- 表面處理：鍍亮鉻
- 用途：冷凍冷藏櫃、廚房設備等

1. The maximum opening angle is 180 degrees.
2. Protruding door design, suitable for enclosures with protruding doors.
3. With spring hinge, with automatic return function.
4. With hinged cover, there is no installation trace after installation.

- Material: Zinc alloy
- Finish: Bright chrome
- Uses: Freezer refrigerators, kitchen equipment, etc.

