

# 不鏽鋼轉角合頁

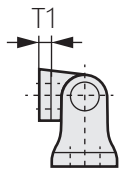

## OH-1727

### Stainless steel corner hinge

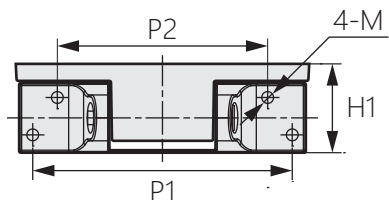
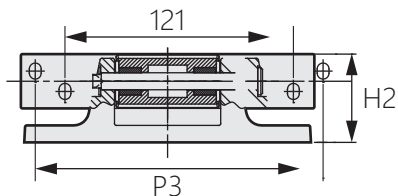

### 商品介紹 Product description

- 1.內裝軸承，轉動順暢。
- 2.左右兼用型。
- 3.使用荷重40kg(縱向使用兩個門時的參考重量)

- 材質：不鏽鋼鑄件(SUS304)
- 表面處理：鏡面拋光
- 用途：冷凍冷藏庫、烘烤設備等。

1. With built-in bearings, it rotates smoothly.
2. Both left and right use type.
3. Use load 40kg (reference weight when using two doors vertically).

- Material: Stainless steel(SUS304)
- Finish: Mirror polishing
- Uses: Freezer storage,baking equipment,etc.

商品型號	P1	P2	P3	H1	H2	T1	M
OH-1727-1	204	146	169	50	62	9	8.5
OH-1727-2	153	124	156	52.3	52	10	6.5