

隱藏式鉸鏈



OH-202

Hidden hinge



商品介紹 Product description

1. 安裝時軸可以抽出，安裝完畢軸插入緊固。
2. 一端焊接式安裝。
3. 左右開門兼用。

- 材質：鋅合金(ZDC)、冷軋鋼板(SPCC)
- 表面處理：黑色烤漆和鍍白鋅
- 用途：機箱機櫃、電器櫃等

1. Axis can be pulled out during installation and inserted securely upon completion.
2. One end welding installation.
3. Open the door on both sides.

- Material: Zinc alloy (ZDC), Cold rolled steel plate (SPCC)
- Finish: Black paint and white zinc plating
- Uses: Chassis cabinets, electrical cabinets, etc.

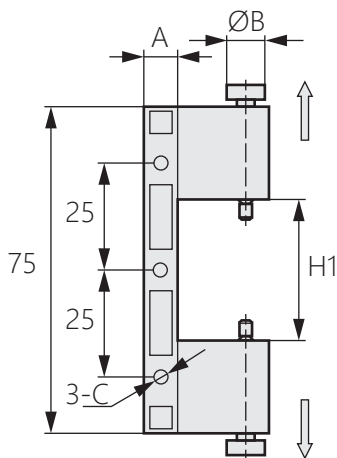

安裝圖

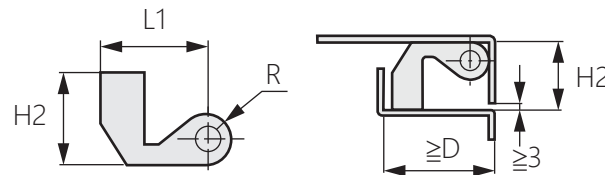
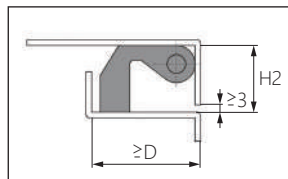

商品型號	H1	H2	L1	A	B	C	D	R
OH-202-1	32	18.5	20.5	8	5.3	M4	> 25	5
OH-202-2	35	24	25	11	7	M5	> 33	6