

外露式鉸鍊

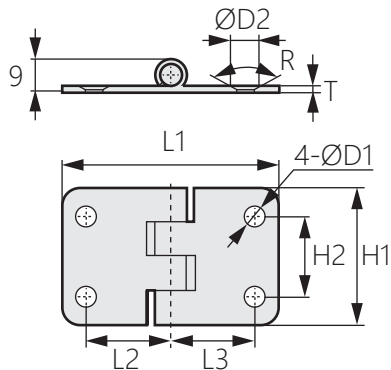

OH-3537

Exposed hinge



商品介紹 Product description

最大開啟角度180度。

- 材質：不鏽鋼SUS304
- 表面處理：震動研磨
- 用途：自動化設備、機箱機櫃等

The maximum opening angle is 180 degrees.

- Material: Stainless steel SUS304
- Finish: Vibration grinding
- Uses: Automation equipment, chassis cabinets, etc.

商品型號	L1	L2	L3	H1	H2	D1	D2	T	R
OH-3537-1	35	23	37	22.5	5.5	8.5	2	94°	
OH-3537-2	48	32	36	20	4	8	2	106°	
OH-3537-3	60	47	38	23	5.5	8.5	1.5	113°	
OH-3537-4	54	24	14	50	34	4	8.5	2	90°