

包膠外牙把手

Folding handle

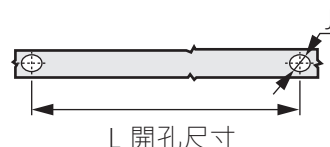

TG-502

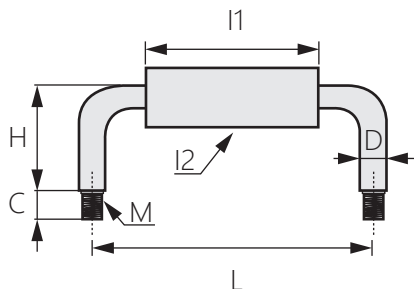

[15.0*3.5底座]

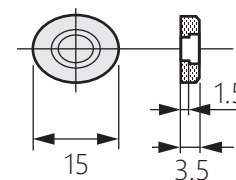

商品介紹 Product description

- 材質：不鏽鋼、鐵
- 表面處理：TG-502-1/鏡光
TG-502-2/鉻
- 備註：如需底座請於型號加上“Z”。

● Material: Stainless steel, iron

● Finish:

TG-502-1/Mirror polishing

TG-502-2/Chromium

● Notes: If you need a base, please add "Z" to the model.

商品型號		L	D	H	M	C	J	I2	I1
不鏽鋼	鐵								
TG-502-1-1	TG-502-2-1	100	Ø9	40	M6	15	Ø7	Ø12.8	77
TG-502-1-2	TG-502-2-2	119	Ø8.8		M8		Ø9		
TG-502-1-3	TG-502-2-3	120			M6		Ø7	Ø18	