

側箱門鎖



TM-071

Side compartment door lock

商品介紹 Product description

- 1.外觀小巧·操作簡易·具有良好的鎖定功能。
- 2.可撞擊式關門和拉動手柄關門。
- 3.左右兼用型。



- 材質：鋅合金
- 表面處理：鍍亮鉻
- 用途：機箱機櫃、電配箱、控制側門等。

1. The appearance is small and exquisite, the operation is simple, and it has a good locking function.
2. The door can be closed by impact and by pulling the handle.
3. Both left and right use type.

- Material: Zinc alloy
- Finish: Bright chrome
- Uses: Chassis cabinets, electrical distribution boxes, control side doors, etc.

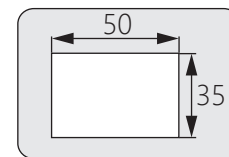
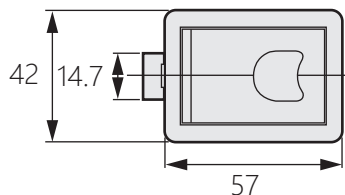
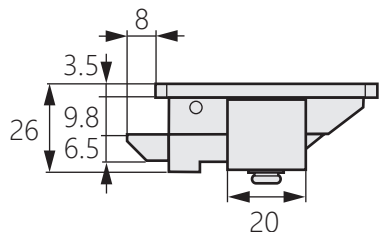

開孔尺寸