

圓頭鎖

Cam lock



TM-1002

商品介紹 Product description

具有密封防水功能。

- 材質：主體(鋅合金)、擋片(冷軋鋼板)
- 表面處理：孔雀綠、環保鋅
- 用途：電箱、網路機櫃、通信機櫃等。

With waterproof sealing.

- Material: Base(ZDC) 、Pawl(SPCC)
- Finish: Malachite green,
Environmentally Friendly Zinc
- Uses: Electrical box, Network cabinet,
communication cabinet ,etc.

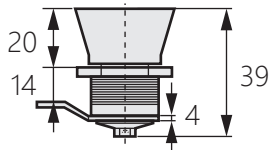
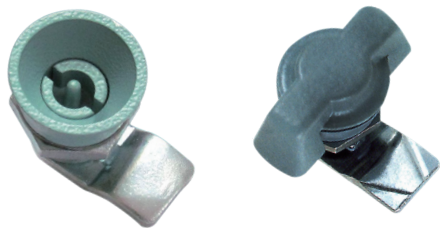

[TM-1002-1] 有鎖

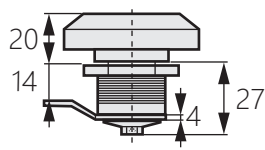

[TM-1002-2] 無鎖

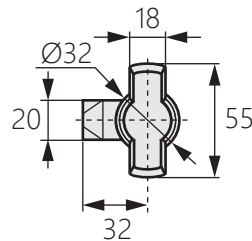
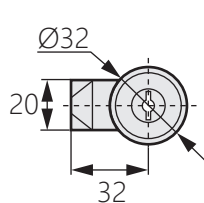

開孔尺寸

