

# 鋅合金門鎖

Zinc alloy latch

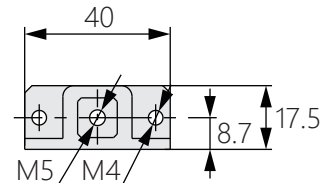

TM-532

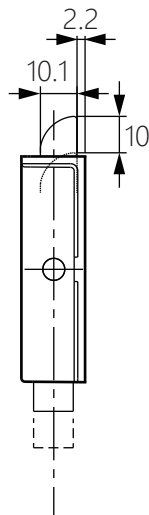
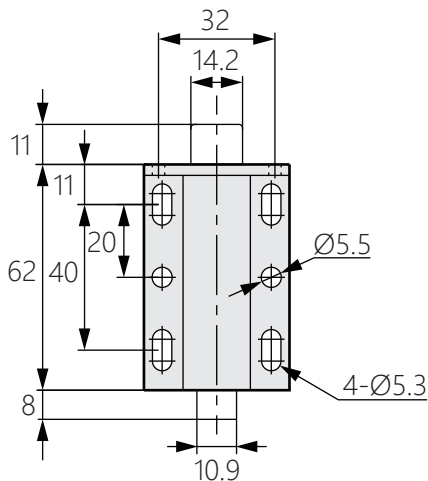

商品介紹 Product description

一鍵式開合。

- 材質：鋅合金 (ZDC)
- 表面處理：鍍鉻
- 用途：配電盤、機床等

One-button opening and closing.

- Material: Zinc alloy (ZDC)
- Finish: Chrome plating
- Uses: Switchboards, machine tools, etc.