

槓桿型壓縮式門扣



Over-center lever latch

商品介紹 Product description

1. 具高強度，安裝及操作簡便。
2. 利用槓桿原理使鎖舌在扣座上產生強大的力矩，加強緊迫效果，最大工作附載 2000N(200KG)(400 lbs)

- 材質：主體-鋁合金(ADC)、插銷-鈦合金
- 表面處理：黑色塗裝
- 備註：TM-6170-2與鋁管TM-6170-L500. TM-6170-L1000為選配件

1. With high strength, easy installation and operation.
2. Use the principle of leverage to make the tongue produce a strong moment on the buckle seat, strengthen the pressing effect, and the maximum working load is 2000N (200KG) (400 lbs)

- Material: Body-Aluminum Alloy (ADC) Bolt-Titanium Alloy
- Finish: Black painting
- Notes: TM-6170-2 and aluminum tube TM-6170-L500. TM-6170-L1000 are optional accessories.



[TM-6170-1]

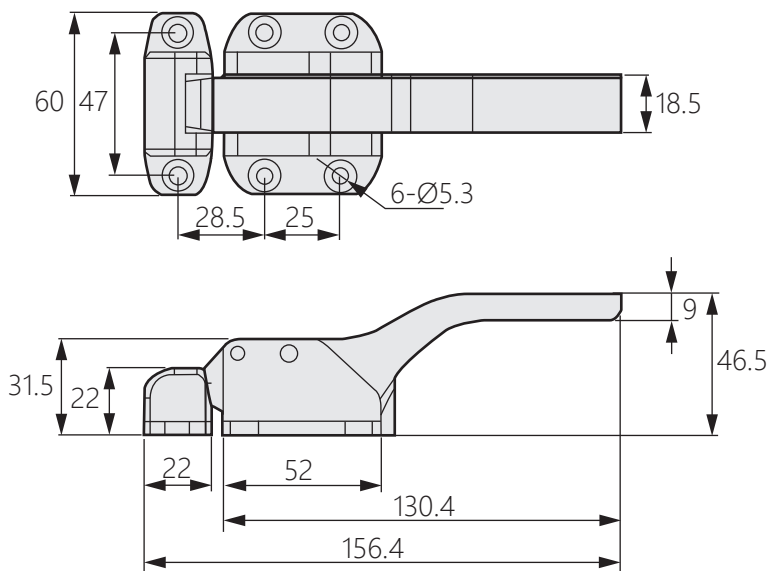

[TM-6170-2]

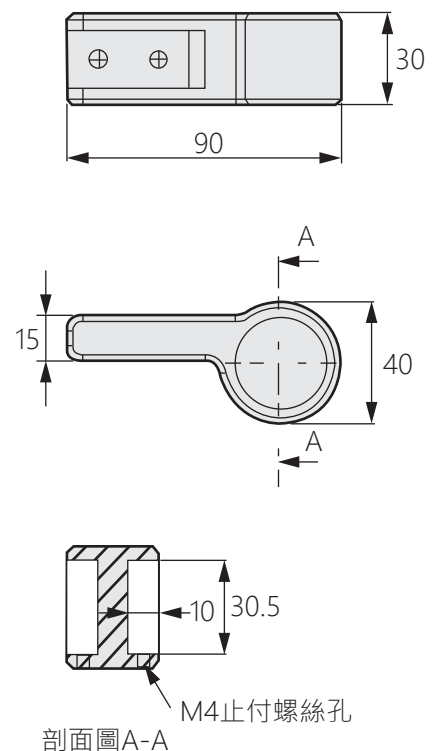

示意圖

