

Compression door lock

商品介紹 Product description

大型·可調間距·

- 材質：鋅合金
- 表面處理：黑色塗裝、電鍍亮鉻
- 備註：多種鎖頭選擇·可選配擋片與取手(TM-2014)、防水蓋(TM-2015)

Large, adjustable pitch.

- Material: Zinc Alloy(ZDC)
- Finish: Black painting、bright chrome plating
- Note: Multiple lock options, optional stop, a variety of lock options, optional baffle and pick(TM-2014), waterproof cover (TM-2015).

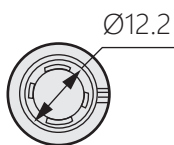
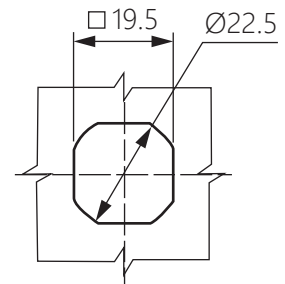
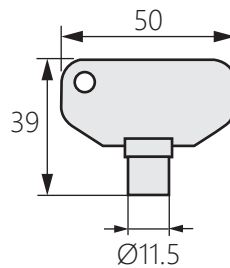
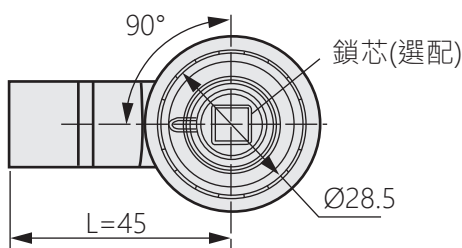
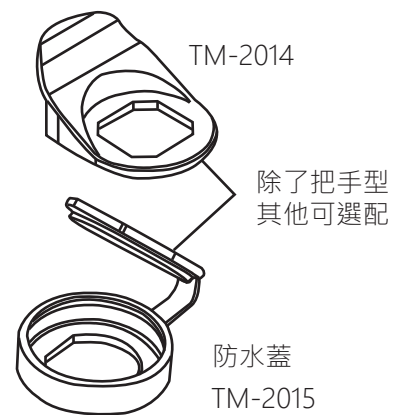
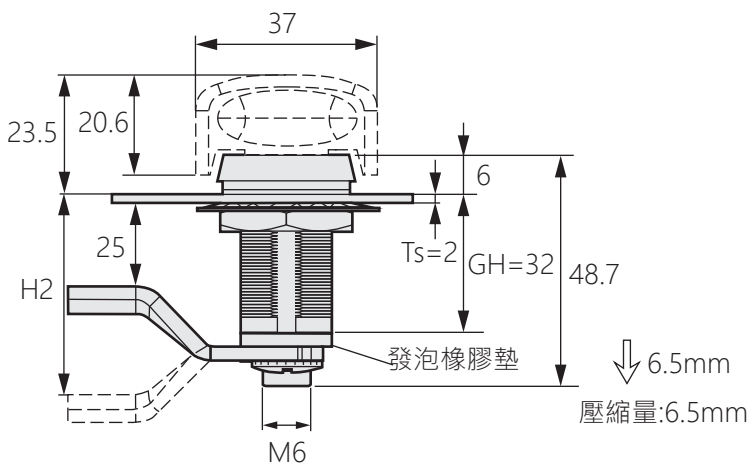

TM-8161-1
鑰匙操縱型

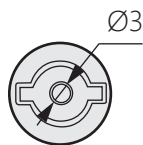

TM-8161-2
雙翅型

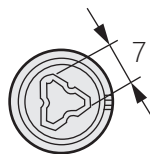

TM-8161-3
三角7

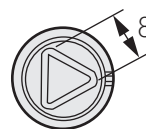

TM-8161-4
三角8

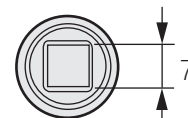

TM-8161-5
四方7



TM-8161-6
四方8

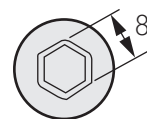

TM-8161-7
內六角8

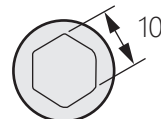

TM-8161-8
外六角10

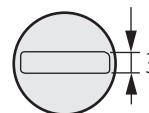

TM-8161-9
一字槽型

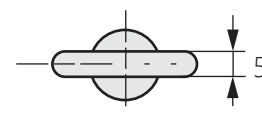

TM-8161-10
把手型