

交通箱鎖



TM-836

Cylinder Locks with Lathes

商品介紹 Product description

轉動鑰匙，門擋回縮8mm，內建彈簧，鑰匙與門擋會自動回到原始位置。



- 材質：基座(不鏽鋼)
鎖芯(鋅合金、銅)
門擋-鋅合金
- 表面處理：鎖芯、門擋-鍍鉻
- 用途：機櫃、控制箱等

Turning the key moves the Cam 8mm. With built in spring, key returns to position where it can be inserted.

- Material: Base (Stainless Steel)
Lock (ZDC & Copper)
Cam - (ZDC)
- Finish: Lock, Cam - Electroplated With Chrom
- Uses: Cabinets, Control box, etc.

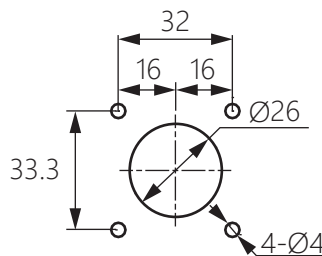
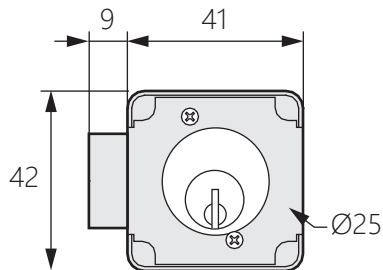

開孔尺寸

安裝示意圖

